



THE HIGHDOWN PAPERS 2019 TO 2021



***VISUAL REPORTS, TEXT DEVELOPMENT AND EVALUATION BY
HAMISH MACGILLIVRAY FOR THE HIGHDOWN GARDENS PROJECT,
WEST SUSSEX***



PART 6: GUIDED TOUR TRAINING

Highdown GARDENS

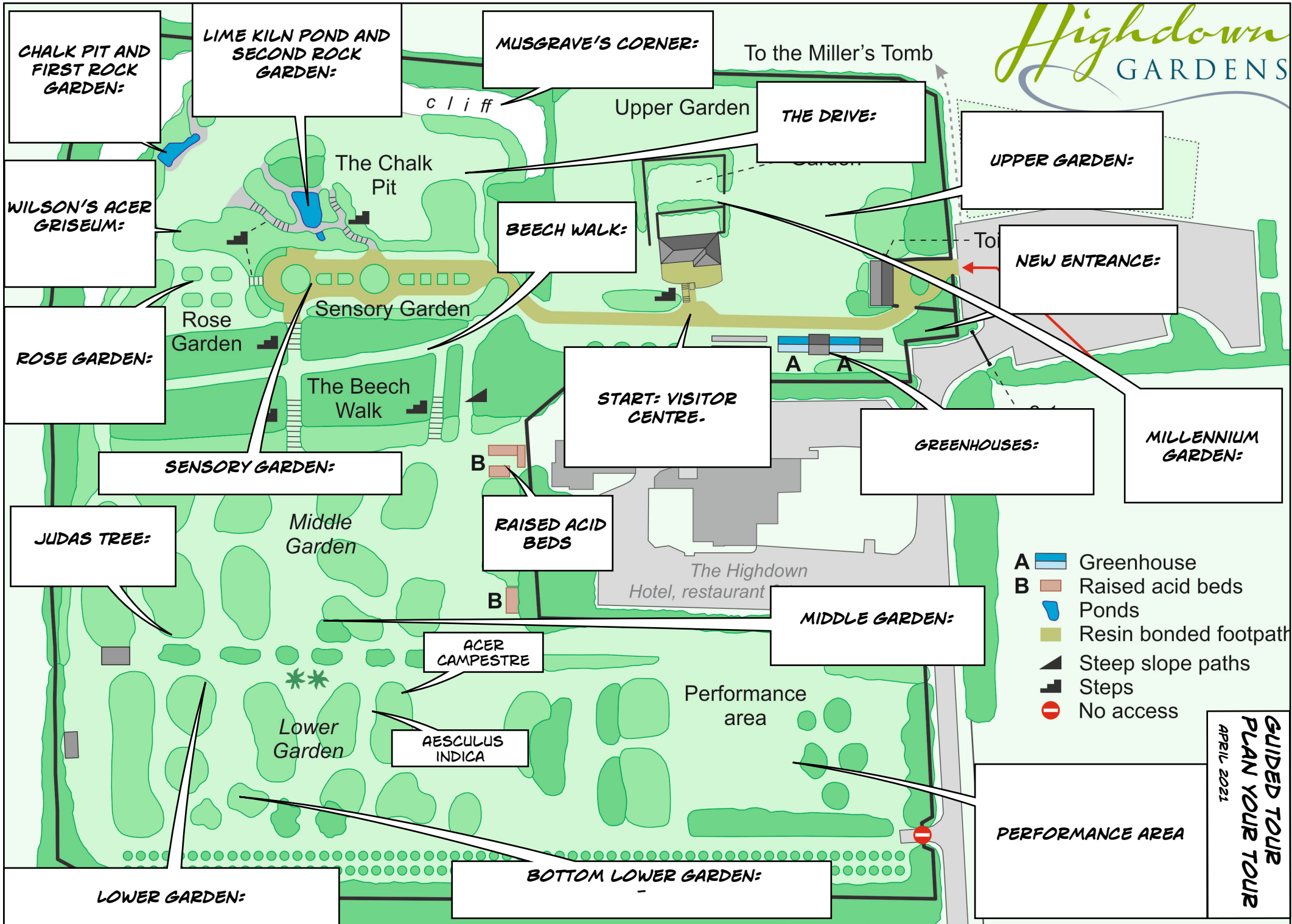

GUIDED TOUR
PLAN YOUR TOUR
 APRIL 2021

Highdown Gardens guided tour information by JH/HM v4 April 2021.

choose 9/10 plant and people stories to create a tour

Key phrases to include:

| | |
|--|--|
| <p>Plants:</p> <ul style="list-style-type: none"> ● Chalk – Highdown Hill ● Then: Experiment – horticulture and chromosomes ● Now: Propagation – library of seeds | <p>People:</p> <ul style="list-style-type: none"> ● Sterns – Jewish ● Obsessions – not just gardens ● Visitors – in footsteps of the good, the political and the scientific |
|--|--|

| | |
|-------|---|
| Place | <h3>1. Start around Visitors centre</h3> |
| Intro | <div style="display: flex; justify-content: space-around;">   </div> <p style="text-align: center;">Sterns and scientists outside Highdown Tower, 1954, WRSO</p> <p>Footsteps. Welcome everybody to Highdown Gardens. We are about to follow in the footsteps of many other previous visitors: the good, the political and the scientific. This tour will take an hour. If you have any questions, ask away.</p> <p>Who came? Visitors have been admiring the Gardens since 1910 including: jockeys, gardeners, politicians, plant hunters, scientists, Jewish cockneys and even the Royal Family. Recent research using the old Highdown Visitors Book has identified some of those visitors. Volunteers last year also transcribed over 3500 index cards written by Stern to help us to start identifying the original collection.</p> <p>PROPS: COULD USE PLAYING CARDS showing photos of visitors</p> <p>The Sterns. Highdown Gardens and the Hotel behind you (Highdown Tower) and the fields behind and below us were once owned by Sir Frederick and Lady Sybil Stern.</p> <p>Their Character. He was tall and humorous and smoked expensive and very strong Turkish cigarettes. He had been in a lot of fighting during WW1 mostly in deserts of Sinai and Negev in what is now Israel. She was also tall and very stylish; a voracious reader and we are just discovering</p> |

| | |
|--------|---|
| | <p>an interest in women's rights. He came from a family of German-Jewish bankers. She came from a Jewish family of artists, activists and poets.</p> <p>Last generation. The Sterns were part of the last generation of Anglo-Jewish aristocrats who were obsessed with horse riding, politics, military life, philanthropy, science and of course gardens.</p> |
| Plants | <p>Chalk. We are standing on a section of Highdown Hill which is solid chalk 85 metres above sea level. It is part of a chain of chalk hills that are the South Downs National Park. This part of the Hill was mined for chalk for use in fields</p> <p>Wild plants that grow on Highdown Hill include sainfoin and the pyramidal orchid as they can survive on very thin soil. If you have the time to go up to the summit and enjoy the view. Pyramidal orchids can also be found in the lawn by the south gate within the gardens.</p> <p>Highdown Gardens. Here in the Gardens we have old plants that were once seeds that travelled from around the world to grow on this chalk as Stern's huge experiment. It is such a unique chalk garden that it has been awarded National Plant Collection status for the plants introduced by Sir Fredrick Stern, in this tour of about an hour we will discover some of these plants and Champion Trees.</p> <p>Champion trees are individual trees which are important examples of their species due to size, age, rarity or historical significance. All champion trees are recorded in the Tree register.</p> <p>Layout. Highdown is designed in garden rooms, in as much as it was ever designed, rather than sweeping vistas. These rooms evolved over 50 years as the Sterns gradually bought more land from local farmers.</p> |
| People | <p>Highdown Hill. For over 3000 years ancient immigrants have used the top of hill for different uses, including as: an Iron Age fort, Bronze Age warehouse, Roman bathhouse and a Saxon cemetery. For over 500 years there has been a windmill. Find the Miller's Tomb after visiting here.</p> <p>Visitor Centre. Converted from 1950s bungalow made for 4th head gardener John Bassindale. Thanks to the National Heritage Lottery Fund that has paid for this construction and many new projects which we will discover on this tour. John Bassingdale's daughter who was raised in this house is one of our volunteers.</p> <p>The Cards and Signatures. Some of the facts about the plants come from 3500 index cards that Stern wrote by hand, usually in fountain pen, to catalogue his collection. They were once stored in that bungalow, now at the West Sussex Record Office</p> |

GUIDED TOUR TRAINING BEFORE AND AFTER.....



MAY 2021 TRAINING WITH GARDEN TEAM, JO LEADING



2 JUNE VIP OPEN DAY, HAMISH READING JOAN LUCAS POEM AT HIGHDOWN GARDENS VISITOR CENTRE

ON NEXT PAGE PLAYING CARDS PROPS FEATURING HIGHDOWN VISITORS: LLOYD GEORGE AND DAUGHTER MEGAN, SCIENTIST JANAKAI AMMAL AND ECOLOGIST SIR EDWARD SALISBURY WITH STERN

